

## Installation for 52022S

Two finishes available: 52022S BN - Brushed Nickel, 52022S CH - Chrome



This item is UL & ULC listed and suitable only for indoor dry locations.

### START FROM HERE

1. Before assembling lighting fixtures, make sure you have electrical wiring experience or have your fixture installed by a qualified licensed electrician.
2. Prepare everything in a clear area.
3. Put on gloves all the time during this installation.
4. Take out fixture and glass from box.
5. Read instructions carefully before you assemble.

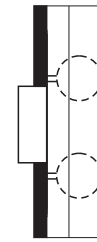

3-1/8"  
SIDE VIEW

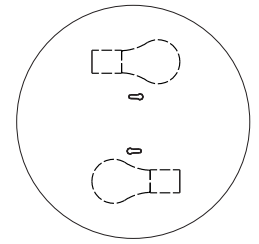

9"  
TOP VIEW

1. Take out the hanging bar (C) from the plastic bag. Screws (B) are already in the bar in the small holes. Screws (A) come separately in the plastic bag and go in the bigger holes.
- \*\* DO NOT SCREW IN SCREWS (B) TO JUNCTION BOX\*\***

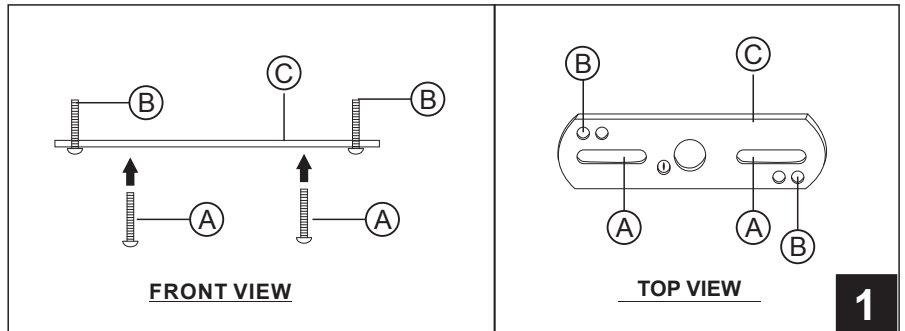

1. Screws (A) are to go into the Junction Box (D)
2. Take out ceiling canopy.
3. Before starting the electrical installation, **\*\*MAKE SURE TO TURN POWER OFF\*\***
4. Checking the ceiling canopy in accordance with local electrical codes before making any connections.
5. Connect the two black fixture wires (E) to the hot 120 volt power line wire with a wire nut.
6. Connect the white fixture wire (F) to the neutral 120 volt power line wire with a wire nut.

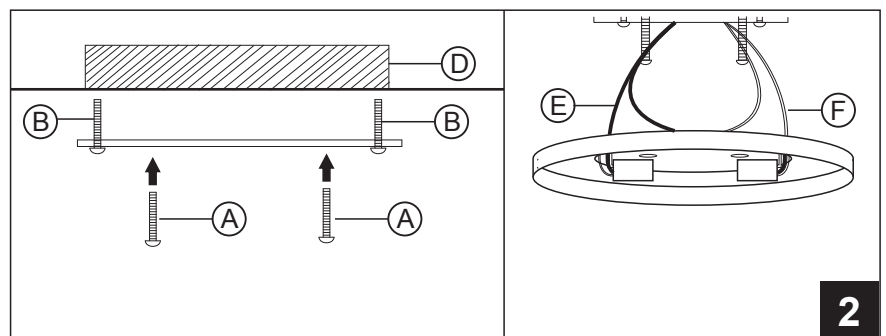

1. Mount the Canopy (G) by attaching it to the two (B) Screws. Push it straight up and turn slightly until Canopy is in place.
2. Tighten screws (B).

